

**Revisions**

Issue	Date	Note
2	22/9/2020	See GTXPDC/213 - PP

**ASSEMBLY VIEW**

**Assembly Instructions**

1) Slide the ferrule onto the cable and strip the cable to the dimensions as shown, taking care not to nick the centre conductor or braid



2) Crimp the pin onto the centre core and slide the pin into the body, ensuring that the cable braid is on the outside of the connector mandril and that the pin is fully located

3) Slide the ferrule forward and crimp

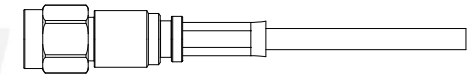

4) Apply adhesive lined heatshrink x 20mm up and over the mandril

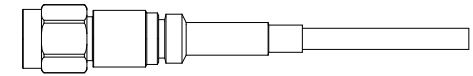

5) Apply heatshrink x 25mm over the top of the first heatshrink

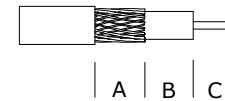
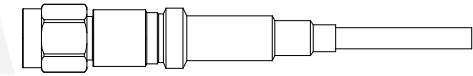

**Strip Dimensions:**

A=6.0mm, B=4.7mm, C=2.5mm

**Crimp Hex. Sizes:**

3.83mm Hex, 0.72mm Hex

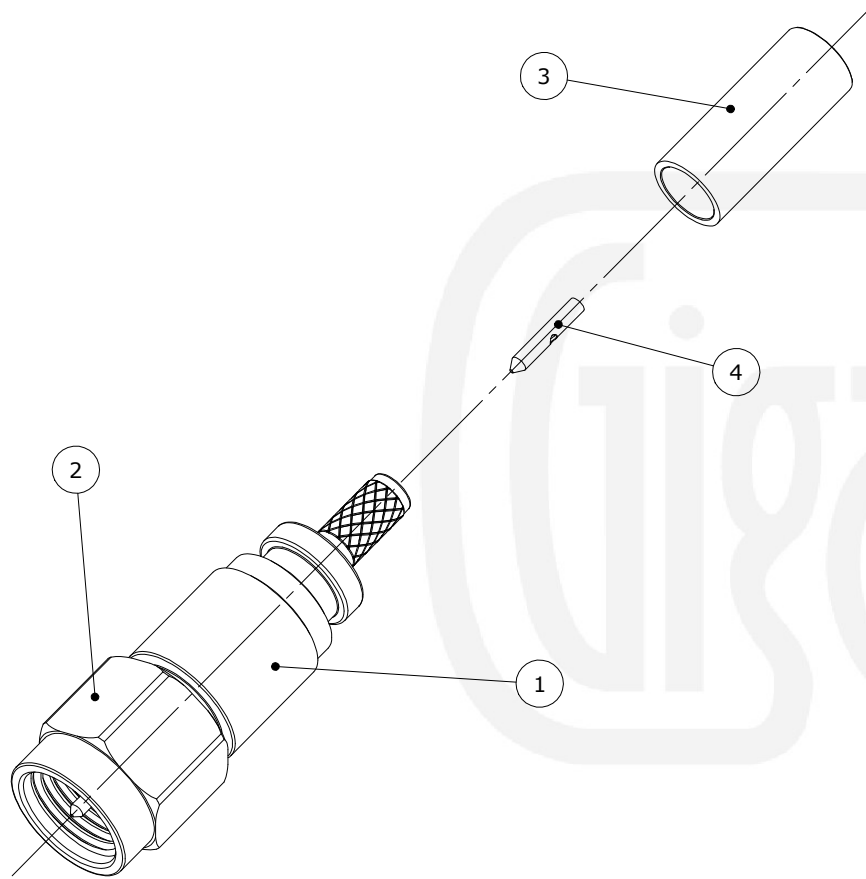

Description	Material	Finish
6 Dielectric	PTFE	White
5 Integral Pin	Phosphor Bronze	Gold
4 Pin	Brass	Gold
3 Ferrule	Brass	Nickel
2 Coupling Nut	Brass	Nickel
1 Body	Brass	Nickel

Unless otherwise specified tolerances  
 0.5-5 = ±0.2  
 >5-30 = ±0.4  
 >30-120 = ±0.6  
 >120-315 = ±1.0  
 >315-1000 = ±1.6  
 Angles = ±5°  
 Units = mm

This document is the confidential property of Gigatronix Limited and may not be copied, reproduced or transmitted to any third party without written authorisation.



<b>Author</b>	PJP
<b>Drawn by</b>	PJP
<b>Drawing date</b>	20/10/2015
<b>Checked by</b>	TM
<b>Checked date</b>	04/11/2015
<b>Scale</b>	Not to scale

**Part Number** MA15-3162-C06WP

**Title:** SMA Waterproof Crimp Plug, IP68, Nickel Plated, RD316